

**The Fountainhead Group, Inc. Owner's Manual**

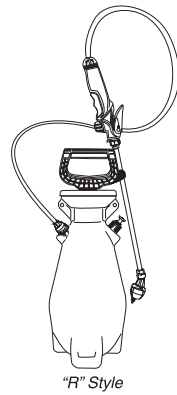

**Do not return sprayer to store, if you experience problems or have questions contact our toll free Customer Service Center, M-F 8 a.m. - 5 p.m., EST, at 1-800-311-9903, or e-mail: [Info@TheFGI.com](mailto:Info@TheFGI.com), or access online at: [www.TheFountainheadGroup.com](http://www.TheFountainheadGroup.com).**

**WARNING**

The sprayer is operated with liquid under pressure. Failure to observe CAUTION and to follow instructions for operating and cleaning can cause tank, hose and other parts to be weakened and rupture under pressure. This can result in serious injury from high pressure discharge of liquids or forcible ejection of parts. **DO NOT USE FLAMMABLE MATERIALS IN THIS SPRAYER.** Material could ignite or explode, causing serious injury and/or possible death. For safe use of this product, you must read and follow all instructions before use.

**SAFETY PRECAUTIONS**

- Read owner's manual completely before operating this sprayer.
- Always wear safety goggles, gloves, and protective clothing when using sprayer.
- Read and follow all instructions and cautions on label of products used in this sprayer.
- Never use flammable liquids, caustics, acids, or hot water in this tank.
- Do not leave sprayer in the sun when not in use.
- Spray when air is calm to prevent drift of chemicals.
- Do not use sprayer near open flame or anything that could cause ignition of the spray.
- Always inspect the hose and all hose connections before each use. A damaged hose, or loose hose connection can result in unintended exposure to the pressurized chemical, resulting in serious injury or property damage.
- Do not lift or carry sprayer by the hose, shut-off valve, or wand extension. Carry by pump handle only, making sure handle is properly locked in place before lifting.
- Do not pressurize with any mechanical device such as an air compressor, since this can create dangerous pressure level and bursting of parts resulting in serious injury. Only use original or replacement pump supplied by the original manufacturer.
- Do not store chemicals in this tank.
- Always release pressure when sprayer is not in use and before removing pump from tank.
- Do not stand with face or body over top of tank when pumping or loosening pump, to prevent pump and/or solution from striking you, resulting in serious injury.
- Clean and rinse sprayer thoroughly after each use.
- Never attempt to alter sprayer from original condition.
- Always use replacement parts from original manufacturer.
- Keep the sprayer and all chemicals out of the reach of children and pets.

**ASSEMBLY INSTRUCTIONS**

**IMPORTANT** Do not attempt to heat or alter hose, hose nut, or barb prior to assembly.

It is recommended to test the sprayer using plain tap water before spraying chemicals. Test all connections for possible leaks. Use proper eye protection while testing. If sprayer does not pass the water test, call our Customer Service Center before using sprayer with chemicals. Make sure hose is not cracked or frayed and does not show signs of swelling. Make sure hose is securely connected to sprayer. **DO NOT USE TOOLS TO TIGHTEN HOSE NUT.**

**Assemble Hose to Tank**

- Slide hose nut back on hose to expose hose barb.
- Push hose barb into tank until it stops. Align hose barb tabs with cutouts in tank.
- Slide hose nut into place and turn clockwise to tighten.

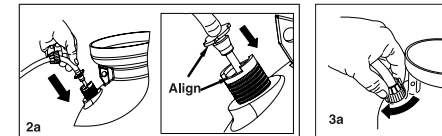
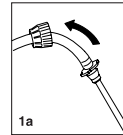

**Assemble Extension to Shut-Off**

- Install the extension onto the shut-off assembly and tighten the nut securely.

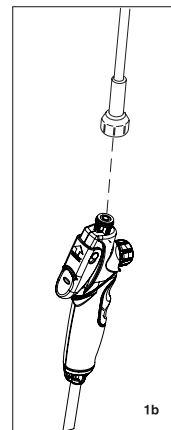

Manual No. 183543 - Manual, R, with 4 in 1 Nozzle  
Rev. A Date: 12/12/2017  
EON17-081  
10" x 27" Folded to 4 1/2" x 3"

**Install the Nozzle**

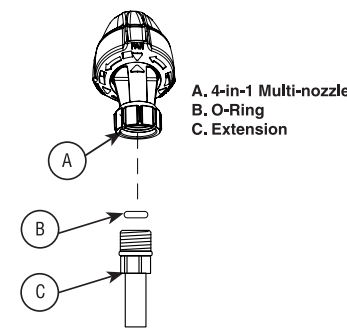

A. 4-in-1 Multi-nozzle  
B. O-Ring  
C. Extension

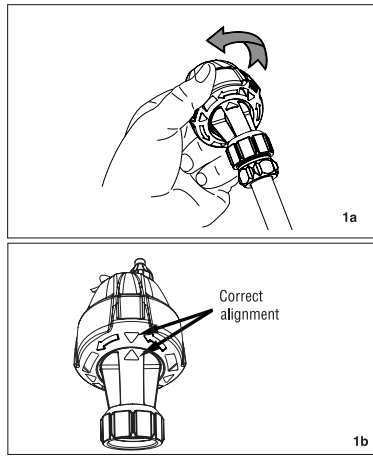

**OPERATING MULTI-NOZZLE**

**IMPORTANT**

**Read Safety Precautions! Always make sure shut-off handle is released before rotating nozzle to different spray setting. Make sure arrow indicators are aligned before spraying. Failure to do so may result in leaks.**

**Rotating**

- While holding shut-off with one hand, rotate multi-nozzle to desired nozzle position.
- Nozzle end will fall into place as arrow indicators become aligned.

MULTI-NOZZLE SETTINGS	
FAN USES:	FOAM USES:
<ul style="list-style-type: none"> <li>Ideal for cleaning decks and siding.</li> </ul>	<ul style="list-style-type: none"> <li>Allows chemicals to cling to horizontal and vertical surfaces for optimal cleaning.</li> <li>Note: For optimal foam, some solutions may require the highest recommended concentrate ratio.</li> </ul>
CONE USES:	STREAM USES:
<ul style="list-style-type: none"> <li>For applying cleaner to large areas.</li> <li>Note: Turn nozzle tip in desired direction to adjust from stream to cone. (1c)</li> </ul>	<ul style="list-style-type: none"> <li>Great for hard to reach areas.</li> <li>Note: Turn nozzle tip in desired direction to adjust from cone to stream. (1c)</li> </ul>

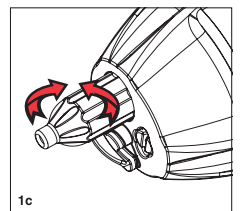

Rinse through the screen with clean, flowing water to flush debris out through the side port. (1d)

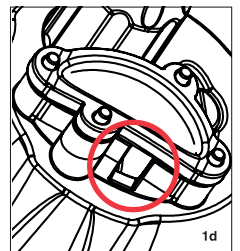

**OPERATING THE SPRAYER**

**IMPORTANT**

**Read Safety Precautions! Always make sure the pressure is released from the tank before filling or servicing.**

**Filling**

Fill the tank to the desired level. (Always refer to chemical manufacturer for proper mixture).

- REMOVE PUMP: Turn handle counter-clockwise.
- INSTALL PUMP: Turn handle clockwise until tightly sealed on tank.

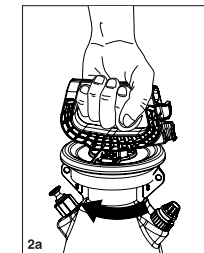
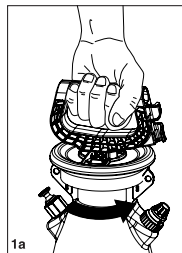

**Pressurizing**

Make sure shut-off handle lock is not engaged. (If lock is engaged while pressurizing, the unit will immediately start spraying.)

- Push down on the handle and turn counter-clockwise to unlock the handle.
- Pump handle in a smooth up and down motion until pressure builds up.
- Push down on handle, turn clockwise to lock in place.

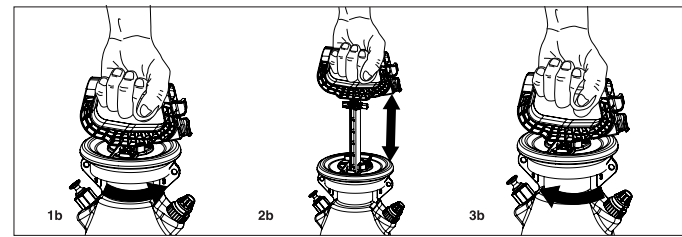

**Spraying and Locking**

- Squeeze shut-off handle to begin spraying.
- Release shut-off handle to stop spraying.
- For continuous spraying, squeeze handle and slide lock as shown.

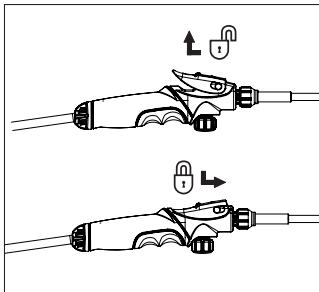

**Release Tank Pressure**

- Pull up Pressure Release Valve (PRV) until all pressure is released.

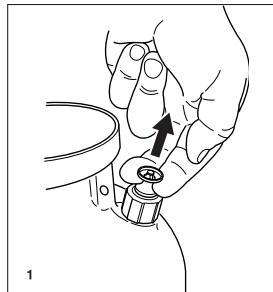

**Finish**

- Depressurize the tank by pulling up on the pressure release valve until all of the pressure is released from the tank as described in the Release Tank Pressure Section.
- Turn the pump handle counter-clockwise to remove the pump.
- Empty any remaining liquid, according to product disposal directions.
- Follow Cleaning instructions.

**Cleaning - AFTER EACH USE, BE SURE TO FOLLOW THE CLEANING INSTRUCTIONS BELOW:**

- Fill the tank with clean tap water. Replace the pump and lighten securely.
- Agitate the tank to rinse the chemicals from the tank wall and pump.
- Remove the pump and dispose of chemical byproduct according to manufacturer's specifications which are located on the original product packaging.
- Refill the tank with clean tap water.
- Make sure the pump is free of dirt and/or debris, and re-install into the tank. Tighten securely.
- Pressurize the tank as described in the Pressurizing section.
- Direct the nozzle away from yourself and squeeze the shut-off handle for at least 30 seconds to clean the hose and shut-off.
- Release pressure as described in the Release Tank Pressure section.
- Remove the pump and dispose of chemical byproduct according to manufacturer's specifications which are located on the original product packaging.
- Repeat steps 1-9 until thoroughly cleaned.

**Sprayer Storage**

- Sprayer tank should be hung upside down, with the pump removed.
- Do not store or leave any solution in tank after use.
- Store in warm, dry location out of direct sunlight.
- Keep the sprayer and all chemicals out of reach of children.

**REGULAR MAINTENANCE Pump & Shut-Off Maintenance**

**Disassembly & Reassembly**

- Remove pump from tank.
- Squeeze tabs that lock cap and pull to unlock.
- Remove handle, lubricate o-ring as required.
- Replace pump cap, align tabs on pump cap and barrel, and push down until tabs lock into place.

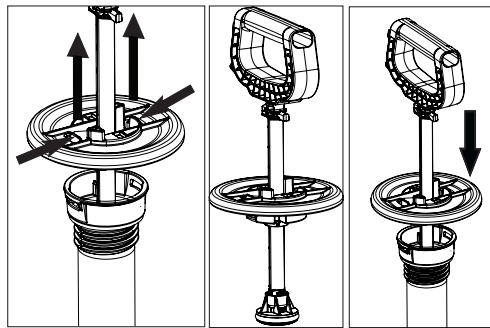

**Shut-Off Maintenance**

- If shut-off clogs, remove the shut-off assembly and check for any obstructions at the dip tube or filter. If none present, disassemble the shut-off assembly.
- Clean the openings of any obstructions and re-assemble tightly securing all sections.
- O-rings dry out and become brittle. Apply petroleum jelly liberally to O-ring(s), as shown, or replace.

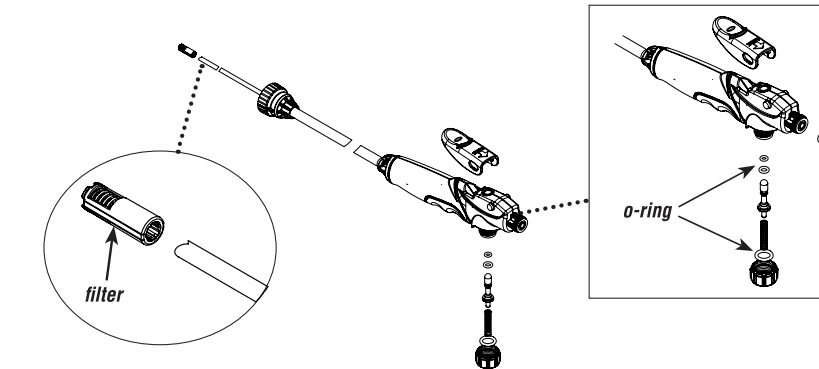

Clean out or replace parts.

**Limited Warranty**

Warranty card is provided in unit parts bag or call our toll free hotline, or access online at [www.TheFountainheadGroup.com](http://www.TheFountainheadGroup.com) to obtain warranty service, contact us at: The Fountainhead Group, Inc., c/o Customer Service, 23 Garden Street, New York Mills, New York 13417, (315) 736-0037 or call prepaid, (800) 311-9903

**SERVICE KITS AND REPAIR PARTS ARE AVAILABLE. Contact Customer Service at 1-800-311-9903. e-mail: [Info@TheFGI.com](mailto:Info@TheFGI.com), or website: [www.TheFountainheadGroup.com](http://www.TheFountainheadGroup.com)**

**TROUBLESHOOTING**

TROUBLE	LOOK FOR	REMEDY
Sprayer starts to spray when pumping or sprayer will not stop spraying when shut-off handle is released.	Shut-off lock is engaged.	Squeeze shut-off handle and disengage the lock.
Sprayer leaks at pump or sprayer does not build pressure.	1. Dirt or debris on pump gasket or closure. 2. Chipped, torn, swollen or defective pump gasket. 3. Check valve at bottom of pump assembly. 4. Inspect o-ring on piston. 5. Loose hose.	1. Clean dirt or debris from gasket or closure. 2. Remove old gasket and replace with new. 3. Replace if missing or damaged. 4. Lubricate the pump as described in Regular Maintenance section. 5. Re-insert hose barb, then tighten hose nut.
Sprayer material overflows through pump barrel or pump handle rises when handle is unlocked.	1. Dirt or debris under check valve on pump. 2. Chipped, torn or swollen pump check valve.	1. Clean check valve and valve sealing surface on pump. 2. Replace check valve.
Hose leaks at tank.	1. Loose hose. 2. Cracked, swollen or faulty hose.	1. Re-insert hose barb, then tighten hose nut. 2. Replace shut-off assembly.
Hose leaks at shut-off.	Swollen, slit or faulty hose	Replace shut-off assembly.
Sprayer is difficult to pump.	1. Damaged piston o-ring. 2. Piston o-ring is dry.	1. Replace piston o-ring. 2. Lubricate the pump as described in Regular Maintenance section.
Nozzle drips when shut-off handle is released.	Dirt or debris in shut-off valve.	1. Replace shut-off assembly. 2. See Shut-off Maintenance section.
Sprayer tank leaks.	Evidence of spray material escaping from the tank.	Replace entire sprayer.
Nozzle tip leaks, poor spray pattern, partial spray or complete stoppage.	1. O-ring is missing or damaged. 2. Spray extension or nozzle clogged. 3. Dip tube filter clogged.	1. Replace o-ring at extension tip. 2. If applicable to sprayer model, remove and clean the extension and nozzle. 3. If applicable to sprayer model, remove and clean the dip tube filter.

**The Fountainhead Group, Inc. Manual de instrucciones**

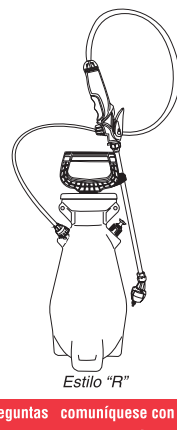

**No devuelva el atomizador a la tienda, si experimenta problemas o tiene preguntas comuníquese con nuestra línea gratuita del Centro de Servicio al Cliente de lunes a viernes de 8 a 5 (hora del Este) al 800-311-9903 o envíe un correo electrónico a: [Info@TheFGI.com](mailto:Info@TheFGI.com), o visite el sitio web [www.TheFountainheadGroup.com](http://www.TheFountainheadGroup.com).**

**ADVERTENCIA**

El atomizador funciona con líquidos bajo presión. Si no observa las PRECAUCIONES y no sigue las instrucciones de operación y limpieza podrá ocasionar el deterioro o ruptura del tanque, la manguera y otras piezas bajo presión. Esto podrá conducir a lesiones graves debido a la descarga de líquido a alta presión o la expulsión forzada de piezas. **NO USE MATERIALES INFLAMMABLES EN ESTE ATOMIZADOR.** El material puede encenderse o explotar, causando lesiones graves y/o posiblemente la muerte. Para un uso seguro de este producto, usted debe leer y seguir todas las instrucciones antes de utilizarlo. **PRUEBE EL ATOMIZADOR CON AGUA ANTES DE USAR PRODUCTOS QUÍMICOS.**

**PRECAUCIONES DE SEGURIDAD**

- Lea completamente el manual del usuario antes de operar este atomizador.
- Siempre utilice gafas protectoras, guantes y ropa protectora cuando use el atomizador.
- Lea y siga todas las instrucciones y precauciones en la etiqueta de los productos usados en este atomizador.
- Nunca use líquidos inflamables, productos cáusticos, ácidos o agua caliente en este tanque.
- No deje el atomizador al sol cuando no esté en uso.
- Rocie cuando no haya viento para evitar el desplazamiento de productos químicos.
- No use el atomizador cerca de llamas expuestas o cualquier elemento que pudiera ocasionar el encendido de la solución de rocío.
- Revise siempre la manguera y todas las conexiones de la manguera antes de cada uso. Una manguera dañada o una conexión suelta pueden producir la exposición no deseada al producto químico presurizado y ocasionar lesiones graves o daños a la propiedad.
- No levante ni transporte el atomizador por la manguera, la válvula de cierre o la extensión de varilla. Transportelo por el mango de la bomba solamente, asegurándose de que el mango esté debidamente trabado en su posición antes de levantar el atomizador.
- No presurice con ningún dispositivo mecánico, como por ejemplo un compresor de aire, ya que esto puede ocasionar un nivel de presión peligroso y que las piezas estallen, produciendo lesiones graves. Sólo utilice la bomba original o la bomba de reemplazo que le suministre el fabricante original.
- No almacene productos químicos en este tanque.
- Libere siempre la presión cuando el atomizador no esté en uso y antes de quitar la manguera del tanque.
- Para impedir que la bomba o la solución le ocasionen lesiones graves, no permanezca de pie con el rostro o el cuerpo sobre el tanque mientras bombea o desajusta la bomba.
- Limpie y enjuague completamente el atomizador después de cada uso.
- Nunca intente alterar el atomizador de su condición original.
- Siempre use piezas de reemplazo del fabricante original.
- Mantenga el atomizador y todos los productos químicos lejos del alcance de los niños.

**INSTRUCCIONES DEL ENSAMBLAJE**

**IMPORTANT** No intente calentar ni alterar la manguera, tuerca de manguera o conector dentado antes del ensamblado.

Se recomienda probar el atomizador utilizando agua de llave antes de utilizarlo para aplicar químicos. Pruebe todas las conexiones para detectar posibles filtraciones. Utilice una adecuada protección para los ojos mientras realice la prueba. Si el atomizador no pasa la prueba del agua, llame a nuestro Centro de Servicio al Cliente antes de utilizarlo con químicos. Asegúrese de que la manguera no esté rajada o desgastada y que no muestre signos de hinchazón. Asegúrese de que la manguera esté conectada firmemente al atomizador. **NO UTILICE HERRAMIENTAS PARA AJUSTAR LA TUERCA DE LA MANGUERA.**

**Ensamble la manguera en el tanque**

- Deslice la tuerca de la manguera hacia atrás para exponer la espiga estriada.
- Inserte la espiga de la manguera en el tanque hasta que tope. Alinee las lengüetas en las hueras con las aberturas del tanque.
- Deslice la tuerca de la manguera hasta su lugar y gire en sentido horario para ajustar.

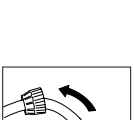

**Ensamble la extensión en el dispositivo de cierre**

- Instale la extensión en el dispositivo de cierre y ajuste la tuerca firmemente.

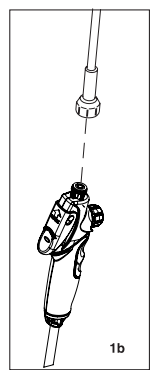

**Instale la boquilla**

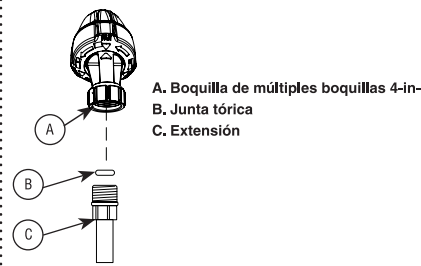

A. Boquilla de múltiples boquillas 4-in-1  
B. Junta tórica  
C. Extensión

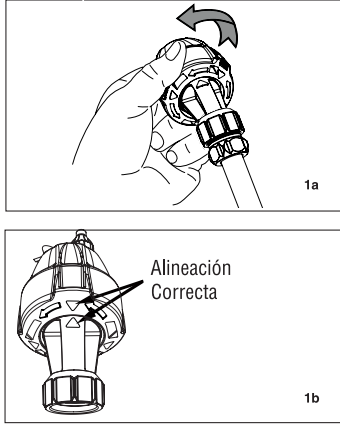

**OPERACIÓN LAS BOQUILLA DE MÚLTIPLES BOQUILLA**

**IMPORTANT**

¡Lea las precauciones de seguridad! Siempre asegúrese de que el mango de la válvula de cierre esté liberado antes de rotar la boquilla a una configuración de rocío diferente. Asegúrese de que los indicadores de flecha estén alineados antes de rociar. No hacerlo podría ocasionar fugas.

**Girar**

- Mientras sostiene el mango de la válvula de cierre con una mano, gire las múltiples boquillas hasta la posición deseada.
- El extremo de la boquilla se ubicará en su lugar a medida que los indicadores de flecha se alineen.

AJUSTES MULTI-BUCLE	
USOS DEL VENTILADOR:	USOS DE ESPUMA:
<ul style="list-style-type: none"> <li>Ideal para limpiar cubiertas y muros.</li> </ul>	<ul style="list-style-type: none"> <li>Permite que los productos químicos se adhieran a superficies planas y verticales para lograr resultados óptimos de limpieza.</li> <li>Note: Para lograr una espuma óptima, es posible que algunas soluciones requieran la mayor concentración recomendada.</li> </ul>
USOS DEL CONO	USOS DE FLUJO:
<ul style="list-style-type: none"> <li>Para aplicar el limpiador en áreas extensas.</li> <li>Note: Gire la punta de la boquilla a la dirección deseada para pasar de un chorro a un cono. (1c)</li> </ul>	<ul style="list-style-type: none"> <li>Ejecente para sitios en áreas difíciles de alcanzar.</li> <li>Note: Gire la punta de la boquilla a la dirección deseada para pasar de un cono a un chorro. (1c)</li> </ul>

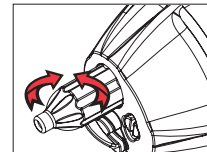

Limpie la pantalla con agua corriente para eliminar los residuos del lado del puerto. (1d)



**CÓMO OPERAR EL ATOMIZADOR**

**IMPORTANT**

¡Lea las precauciones de seguridad! Asegúrese siempre de liberar la presión del tanque antes de llenarlo o limpiarlo.

**Llenado**

Llene el tanque al nivel deseado. (Consulte siempre las instrucciones del fabricante del producto químico para la mezcla apropiada).

- RETIRAR LA BOMBA: gire el mango en sentido antihorario.
- INSTALAR LA BOMBA: gire el mango en sentido horario hasta que esté fuertemente sellado al tanque.

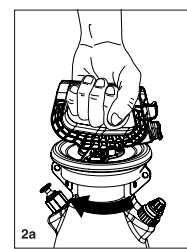
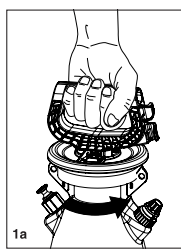

**Presurización**

Asegúrese de que el seguro del mango de cierre no esté trabado. (si el seguro del mango cierre está trabado durante la presurización, la unidad comenzará a rociar de inmediato.)

- Empuje hacia abajo el mango y gírelo en sentido antihorario para destrabar el mango.
- Bombée el mango con un movimiento suave de arriba hacia abajo hasta que aumente la presión.
- Presione el mango hacia abajo, gire en sentido horario para asegurarlo en el lugar.

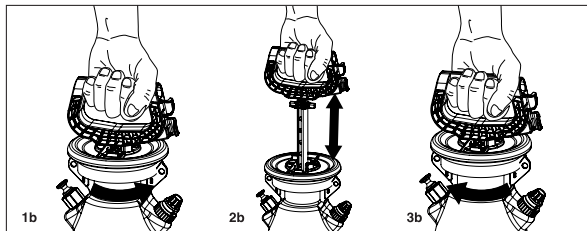

CONT